

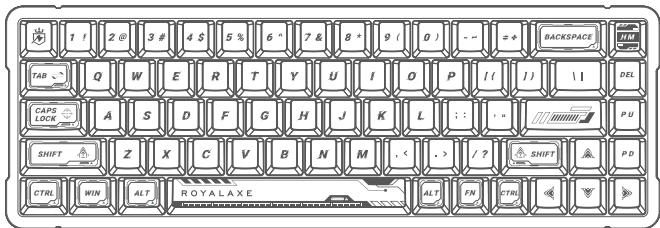

ROYALAXE



# 御斧<sup>®</sup> X68

有线磁轴游戏键盘  
Wired magnetic axis game keyboard



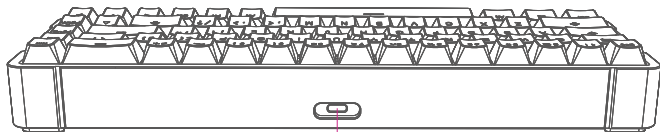
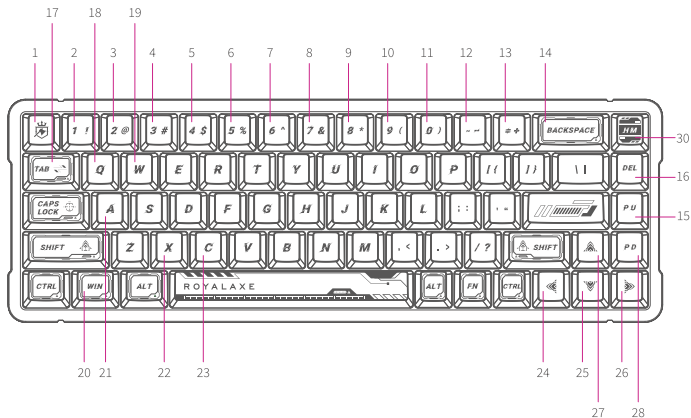

使用说明书  
USER MANUAL

# 中文版



29

## 键盘功能概述

1. Fn+  : 恢复出厂设置
2. Fn+ **1** : F1功能键 (WIN)  
: 降低屏幕亮度 (MAC)
3. Fn+ **2** : F2功能键 (WIN)  
: 提高屏幕亮度 (MAC)
4. Fn+ **3** : F3功能键 (WIN)  
: 显示多任务窗口 (MAC)
5. Fn+ **4** : F4功能键 (WIN)  
: 打开控制台 (MAC)
6. Fn+ **5** : F5功能键 (WIN)  
: 返回app exposé功能 (MAC)
7. Fn+ **6** : F6功能键 (WIN)  
: 搜索 (MAC)
8. Fn+ **7** : F7功能键 (WIN)  
: 上一曲 (MAC)
9. Fn+ **8** : F8功能键 (WIN)  
: 暂停 (MAC)
10. Fn+ **9** : F9功能键 (WIN)  
: 下一曲 (MAC)
11. Fn+ **0** : F10功能键 (WIN)  
: 静音 (MAC)
12. Fn+ **-\_** : F11功能键 (WIN)  
: 音量- (MAC)
13. Fn+ **+=** : F12功能键 (WIN)  
: 音量+ (MAC)
14. Fn+ **Back**: 长按3秒, 数字区和F区功能转换,  
1-0=区域变为F1-F12
15. Fn+ **PgUp** : 切换侧灯呼吸和长亮
16. Fn+ **DEL** : 关闭侧灯
17. Fn+ **Tab** : 关闭键盘背光
18. Fn+ **Q** : 灯效循环切换
19. Fn+ **W** : 长按方向区与WASD互换长按3秒, 短按解锁
20. Fn+ **Win** : 长按3秒, Win锁定;短按解锁
21. Fn+ **A** : 主背光颜色切换  
(顺序: 七彩、红、橙、黄、绿、青、蓝、紫、白)
22. Fn+ **X** : 切换Windows系统背光灯闪三下
23. Fn+ **C** : 切换MAC系统背光灯闪三下
24. Fn+  : 主背光速度-
25. Fn+  : 主背光亮度-
26. Fn+  : 主背光速度+
27. Fn+  : 主背光亮度+
28. Fn+ **PgDn** : 触发insert按键功能
29. Type-C有线接口
30. Fn+ **HM** : 触发END按键功能  
Win+ **Tab** : 显示多任务窗口 (Win)  
Win+ **D** : 打开控制台 (Win)  
**Ctrl**+ **Shift** 切换输入法  
Fn+ **Shift**+ **ESC** : 触发-功能

## 有线模式连接

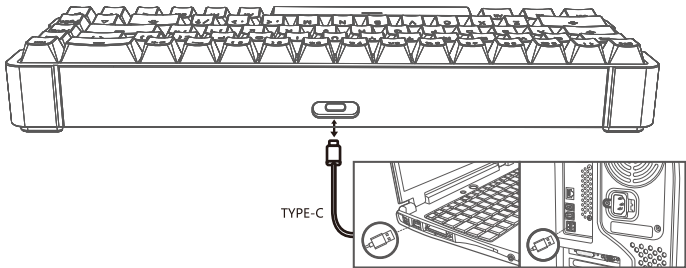

充电线TYPE-C接口插入键盘，USB接口连接到您的电脑。

## 主键区灯效

顺序	常亮(默认)、随波逐流、碧波荡漾、繁星点点、川流不息、如影随形、重峦叠嶂、正弦波、彩泉涌动、踏雪无痕、百花争艳、一石二鸟、峰回路转、多彩纵横、满天飞雪、流星、动态呼吸、光谱循环、自定义(驱动)、音乐律动电音(驱动)、音乐律动经典(驱动)、光影模式(驱动)
速度	默认4档，开机第3档
亮度	默认4档，开机最高亮度

## 侧边灯效

灯效	长亮模式/呼吸模式
----	-----------

## 自定义驱动



自定义模式请扫码下载官方驱动程序或：  
[www.royalaxe.cn](http://www.royalaxe.cn)

温馨提示：驱动程序仅支持有线模式链接下自定义。

## 技术规格

- 连接方式:有线
- 工作电流电压:5V 500mA(max)
- 键盘按键数:68 =
- 键帽材质:PBT
- 键盘产品尺寸:317.2x107.2x44mm
- 重量:1174 ± 20g

## 系统要求

- 1 x USB端口
  - Windows® 7,Windows® 8,Windows® 10或更高版本, Android 3.2或更高版本;  
Mac OS 10.5或更高版本
- 注意:不同系统版本中的多媒体功能会有部分无效。

## 故障排除

1. 确保将产品的USB 无线接收器正确插入到电脑的USB端口。
2. 确保电脑满足最低系统要求。
3. 产品和无线接收器超出有效连接距离,请减少产品和接收器之间的距离。

## 注意

- 清洁产品请使用干燥、柔软的棉织品等。
- 不要折叠弯曲本产品。
- 不要强行拆卸本产品。
- 不要淋雨或暴晒或火烤。
- 不要直接用水冲洗
- 基于USB协议,键盘额定充电电压为5V,请使用电脑USB接口对键盘进行充电,禁止使用充电器对键盘充电。
- 产品使用过程中禁止液体流入产品内部,造成产品线路短路引起电性不良。

## 轴体更换方法:

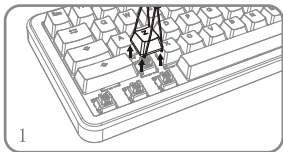

用拔键器取下键帽。

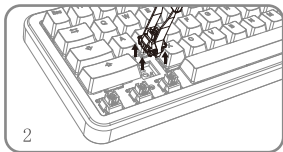

用拔轴器将轴体拔出。



将要换的轴校对安装位置, 对齐孔位。



将新轴放置在卡位上。

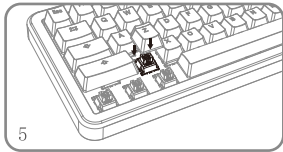

轻按新轴装入卡位内。

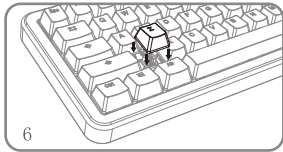

装上键帽, 即可正常使用。

## 重要安全性和合规性信息

### 产品和包装材料的废弃



#### 废旧电气和电子设备

产品或其包装上的这一标记表明,根据欧洲指令2012/19/EU对废旧电器和电子产品的管理,该产品不能与普通生活垃圾一起处理。你有责任通过指定的废旧电器及电子设备收集处处置这些设备。正确处理废旧产品将有助于防止对环境 and 人类健康造成潜在的负面后果。

### CE 符合性声明

此设备符合在电磁兼容指令 (2014/30/EU)、RoHS 指令 (2011/65/EU) 和无线电设备指令 (2014/53/EU) 方面协调统一各成员国法律的理事会指令所规定的要求 (针对无线电设备)。

此产品经检测证实,符合与信息技术设备相关的协调标准,这些协调标准依照欧盟官方公报的指令进行发布。

### 中国 RoHS

根据中国大陆《电器电子产品有害物质限制使用管理办法》(也称为中国大陆RoHS),以下部分列出了本产品中可能包含的有害物质的名称和含量。

部件名称	有害物质					
	铅 (Pb)	汞 (Hg)	镉 (Cd)	六价铬 (Cr(VI))	多溴联苯 (PBB)	多溴二苯醚 (PBDE)
电缆线/电源	×	○	○	○	○	○
电路板组件	×	○	○	○	○	○
塑料/其他部件	○	○	○	○	○	○
玻璃部件	×	○	○	○	○	○
金属部件	×	○	○	○	○	○

本表格依据SJ/T 11364 的规定编制。

○:表示该有害物质在该部件所有均质材料中的含量均在GB/T 26572 规定的限量要求以下。

×:表示该有害物质至少在该部件的某一均质材料中的含量超出GB/T 26572 规定的限量要求。

备注:以上“×”的部件中,部分含有有害物质超过是由于目前行业技术水平所限,暂时无法实现替代或减量。因型号不同,产品可能不包括上述所有部件,请以产品实际销售配置为主。

**10** 本产品的环保使用期限为10年。

环保使用期限的参考标准,取决于产品正常工作的温度和湿度等条件。

电器电子产品有害物质限制使用管理办法说明:该电器电子产品含有某些有害物质,在环保使用期限内可以放心使用,超过环保使用期限之后应该进入回收循环系统。《废弃电器电子产品回收处理管理条例》提示性说明为了更好地关爱及保护地球,当用户不再需要此产品或产品寿命终止时,请遵守国家废弃电器电子产品回收处理相关法律法规,将其交给当地具有国家认可的回收处理资质的厂商进行回收处理,不当利用或者处置可能会对环境和人类健康造成影响。



R O Y A L A X E

## 保修卡

尊敬的客户:

整机自购买日期开始一年内,针对产品包装内所有的硬件产品,若出现质量问题,将为持此保修卡用户提供免费保修服务,其余保修条例按国家《微型计算机商品修理更换退货责任规定》。同时此服务仅限于出现质量问题的产品,而不包括赔偿购买者利益损失及其他意外情况造成的任何直接或间接损失。

属于下列情况之一的产品,不实行三包:

- 1.无有效三包凭证及有效发票的(能够证明该产品在三包有效期内的除外)或超过三包有效期的或擅自涂改三包凭证的。
- 2.三包凭证上的产品型号和编号与产品实物不相符合的。
- 3.产品上的型号、序列号或生产日期代码已被更改、删除或难以辨认。
- 4.缺陷是超出预期用途的过度使用造成的,例如在商业环境中不停地使用。
- 5.未按产品使用说明的要求使用,维护,保管而造成损坏的。
- 6.在使用过程中,使用盗版软件或计算机病毒造成的损坏。
- 7.未经授权的维修服务点或人员对产品进行修理或改动的。
- 8.因不可抗力造成损坏的。
- 9.产品在使用过程中,因意外、信号干扰或其他影响因素造成的无线连接丢失而不能正常工作。
- 10.正常磨损缺陷,或自然损耗件。
- 11.产品因未在最初设计、制造或批准使用的国家/地区使用而无法正常工作,进口产品可能会出现这种情况。

保修办法:

- (1)7天内出现质量问题,根据国家“三包”规定于产品外观与包装完整的情况下将硬件退还给购买地点,凭购买的有效凭证,退回您所支付的硬件产品货款。
- (2)60天内出现产品质量问题,您可以到购买地点更换硬件产品,或者到指定的维修网点保修,更换之后的硬件保质期为保持期剩余的天数。
- (3)1年内出现产品质量问题,您可以到指定的维修网点保修。



商品信息	商品名称	
	产地	
	商品型号	
	出厂编号	
用户信息	用户姓名	
	用户地址	
	联系电话	
	邮编	
销售商信息	销售商名称	
	销售商地址	
	联系电话	
	邮编	
	销售日期	
	发票号码	
	销售商印章	
<p>尊敬的用户，以上信息由销售商负责填写，请您理解和配合，谢谢。            以下的信息由维修单位填写，并最终交还于您。</p>		
维修信息	维修单位名称	
	地址	
	联系电话	
	邮编	
	维修单据号	
	维修日期	
	维修人员签字	



Company website

运营商：广东御斧科技有限公司

Operator: Guangdong Royal Axe Technology Co., Ltd

地址：广东省东莞市谢岗镇振兴北路23号

Address: No. 23 Zhenxing North Road, Xiegang Town,  
Dongguan, Guangdong, China

公司官网Web: [www.royalaxe.cn](http://www.royalaxe.cn)

执行标准Execution Standard: GB/T14081-2010



廢電池  
請回收



Made in China

# ENGLISH

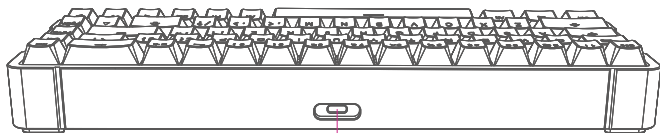
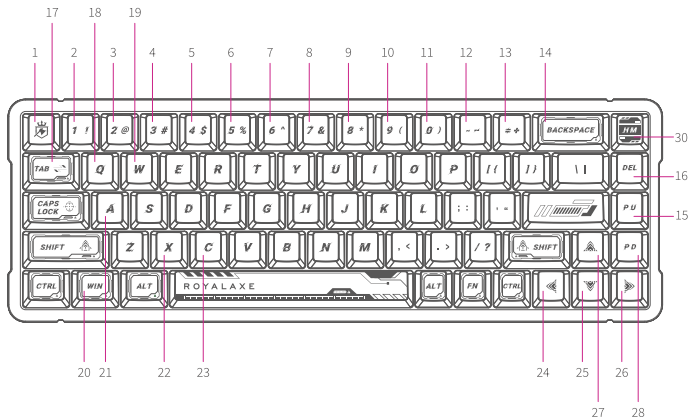

29

## FUNCTION OVERVIEW OF THE KEYBOARD

1. Fn+  : Reset
  2. Fn+ **1** : F1 function key (WIN)  
: Screen brightness- (MAC)
  3. Fn+ **2** : F2 function key (WIN)  
: Screen brightness+ (MAC)
  4. Fn+ **3** : F3 function key (WIN)  
: Multi screen display (MAC)
  5. Fn+ **4** : F4 function key (WIN)  
: Open the console (MAC)
  6. Fn+ **5** : F5 function key (WIN)  
: return app exposé (MAC)
  7. Fn+ **6** : F6 function key (WIN)  
: search (MAC)
  8. Fn+ **7** : F7 function key (WIN)  
: Prev song (MAC)
  9. Fn+ **8** : F8 function key (WIN)  
: Play/Pause (MAC)
  10. Fn+ **9** : F9 function key (WIN)  
: Next song (MAC)
  11. Fn+ **0** : F10 function key (WIN)  
: Mute (MAC)
  12. Fn+ **-** : F11 function key (WIN)  
: Volume- (MAC)
  13. Fn+ **+=** : F12 function key (WIN)  
: Volume+ (MAC)
  14. Fn+ **Back** : Press and hold for 3 seconds to switch the functions of the number area and F area. The 1-0= area will change to F1-F12.
  15. Fn+ **PgUp** : Side lamp breathing and long-illumination mode
  16. Fn+ **DEL** : Turn off the side lights
  17. Fn+ **Tab** : Turn off the backlight of the keyboard
  18. Fn+ **Q** : Cycle switching of lighting effects
  19. Fn+ **W** : Press and hold the direction pad and swap it with WASD. Hold for 3 seconds and then press briefly to unlock.
  20. Fn+ **Win** : Long press for 3 seconds to lock the screen; short press to unlock.
  21. Fn+ **A** : Main backlight color switching (Sequence: Rainbow, Red, Orange, Yellow, Green, Cyan, Blue, Purple, White)
  22. Fn+ **X** : Switch to Windows , the white light flashes three times.
  23. Fn+ **C** : Switch to MAC , the blue light flashes three times.
  24. Fn+  : Backlight frequency-
  25. Fn+  : Backlight brightness-
  26. Fn+  : Backlight frequency+
  27. Fn+  : Backlight brightness+
  28. Fn+ **PgDn** : Trigger the function of the insert key
  29. Type-C/Wired interface
  30. Fn+ **HM** : Trigger the function of the END key
- Win+ **Tab** : Show multitasking window (Win)
- Win+ **D** : Open the console (Win)
- Ctrl+ Shift** Switch input method
- Fn+ **Shift+ESC** : Trigger ~ function

## WIRED CONNECTION

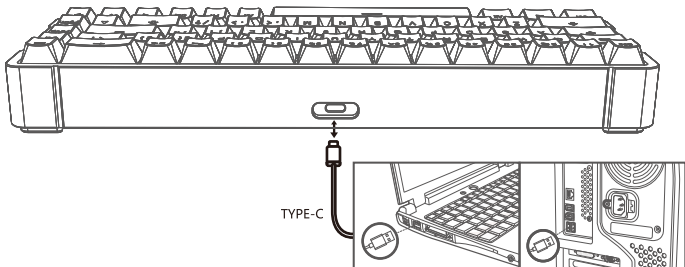

Insert the TYPE-C interface of the charging cable into the keyboard, and connect the USB interface to your computer.

## KEY PRESS LIGHT EFFECT

sequence	Constantly on (default), drifting along with the current, rippling water surface, twinkling stars, continuous flow, following closely like a shadow, overlapping mountains and ridges, sine wave, surging colorful waterfalls, leaving no trace in the snow, competing for beauty with various flowers, killing two birds with one stone, turning back and forth with twists and turns, diverse and overlapping, flying snow all over the sky, shooting stars, dynamic breathing, spectral cycle, custom (driver), music rhythm electronic music (driver), music rhythm classic (driver), light and shadow mode (driver)
Speed	Default 5 gears, 3rd gear at turn on the machine
Brightness	Default 5 gears, Maximum brightness at startup

## SIDE LIGHT EFFECT

Lighting	Constant-on mode / Breathing mode
----------	-----------------------------------

## CUSTOM DRIVE



For custom mode, please scan the code to download the official driver:

[www.royalaxe.cn](http://www.royalaxe.cn)

Reminder: The driver only supports customization in wired .

## TECHNICAL SPECIFICATIONS

- Connection method: wired
- Working current and voltage: 5V  $\leq$  500mA(max)
- Keyboard keys: 68
- Keycap material: PBT
- Keyboard product size: 317.2x107.2x44mm
- Weight: 1174g  $\pm$  20g

## SYSTEM REQUIREMENT

1. 1 x USB port
2. Windows® 7, Windows® 8, Windows® 10 or later,  
Mac OS 10.5 or later  
Note: Multimedia functions are partially invalid in different OS versions.

## TROUBLE SHOOTING

1. Make sure that the USB wireless receiver of the product is correctly plugged into the USB port of the computer.
2. Make sure the computer meets the minimum system requirement.
3. If the distance between the product and the receiver exceeds an effective range, please reduce the distance for better performance.

## ATTENTION

1. Please use dry and soft cloth to clean the product.
2. Do not disassemble the product by force.
3. Do not get in the rain or in the sun or fire.
4. Do not flush directly with water.
5. Based on the USB protocol, the rated charging voltage of the keyboard is 5V. Please use the USB interface of the computer to charge the keyboard. It is forbidden to use the charger to charge the keyboard.
6. During the use of the product, it is forbidden for liquid to flow into the product, resulting in short circuit of the product and poor electrical properties.

## SHAFT REPLACEMENT METHOD

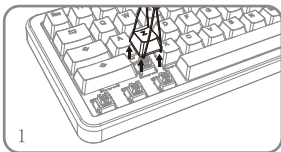

1 Use a keycap puller to unplug the key caps.

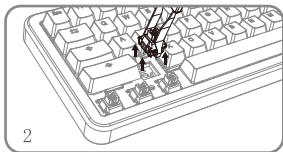

2 Pull out the switch with a switch puller.

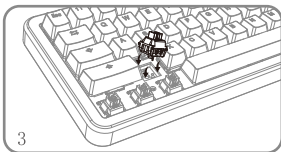

3 Check the installation position of the switch to be replaced and align the hole positions.



4 Place the new switch on the slot.

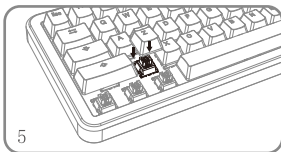

5 Gently press the new switch to install it into the slot.

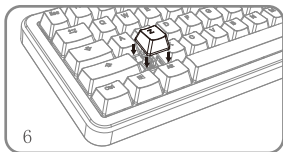

6 Install the keycap, you can use it normally.

# IMPORTANT SAFETY AND COMPLIANCE INFORMATION

## Disposal of product and packing material

Waste Electrical and Electronic Equipment-WEEE



This symbol on the product or on its packaging indicates that this product must not be disposed of with your household waste. Instead, it is your responsibility to dispose of your waste equipment by handing it over to a designated collection point for the recycling of waste electrical and electronic equipment. The separate collection and recycling of your waste equipment at the time of disposal will help to conserve natural resource and ensure that it is recycled in a manner that protects human health and the environment. For more information about where you can drop off your waste equipment for recycling, please contact the local city office, the household waste disposal service or the shop where you purchased the product.

## CE Declaration of Conformity

This device complies with the requirements set out in the Council Directive on the Approximation of the Laws of the Member States relating to Electromagnetic Compatibility Directive (2014/30/EU), RoHS directive (2011/65/EU) and Radio Equipment Directive (2014/53/EU) (for Radio Equipment). This product has been tested and found to comply with the harmonized standards for Information Technology Equipment, these harmonized standards published under Directives of Official Journal of the European Union.

## Federal Communications Commission (FCC) Notice

This equipment has been tested and found to comply with the limits for a Class B digital device, pursuant to Part 15 of the FCC Rules. These limits are designed to provide reasonable protection against harmful interference in a residential installation. This equipment generates, uses and can radiate radio frequency energy and, if not installed and used in accordance with the instructions, may cause harmful interference to radio communications.

However, there is no guarantee that interference will not occur in a particular installation. If this equipment does cause harmful interference to radio or television reception, which can be determined by turning the equipment off and on, the user is encouraged to try to correct the interference by one or more of the following measures:

- Reorient or relocate the receiving antenna.
- Increase the separation between the equipment and receiver.
- Connect the equipment into an outlet on a circuit different from that to which the receiver is connected.
- Consult the dealer or an experienced radio/TV technician for help.

Changes or modifications not expressly approved by the party responsible for compliance could void the user's authority to operate the equipment.

THIS CLASS B DIGITAL APPARATUS MEETS ALL REQUIREMENTS OF THE CANADIAN INTERFERENCE - CAUSING EQUIPMENT REGULATIONS.

## FCC Compliance Statement

This device complies with Part 15 of the FCC Rules. Operation is subject to the following two conditions: (1) this device may not cause harmful interference, and (2) this device must accept any interference received, including interference that may cause undesired operation.

## Commission Federale de la Communication

Cet équipement a été testé et déclaré conforme aux limites des appareils numériques de classe B, aux termes de l'article 15 Des règles de la FCC. Ces limites sont conçues de façon à fournir une protection raisonnable contre les interférences nuisibles dans le cadre d'une installation résidentielle.

CET appareil produit, utilise et peut émettre des hyperfréquences qui, si l'appareil n'est pas installé et utilisé selon les consignes données, peuvent causer des interférences nuisibles aux communications radio. Cependant, rien ne peut garantir l'absence d'interférences dans le cadre d'une installation particulière. Si cet appareil est la cause d'interférences nuisibles pour la réception des signaux de radio ou de télévision, ce qui peut être décelé en fermant l'équipement, puis en le remettant en fonction, l'utilisateur pourrait essayer de corriger la situation en prenant les mesures suivantes:

- Réorienter ou déplacer l'antenne de réception.
- Augmenter la distance entre l'équipement et le récepteur.
- Brancher l'équipement sur un autre circuit que celui utilisé par le récepteur.
- Demander l'aide du marchand ou d'un technicien chevronné en radio/ télévision.

Toutes modifications n'ayant pas reçu l'approbation des services compétents en matière de conformité est susceptible d'interdire à l'utilisateur l'usage du présent équipement.

CET APPAREIL NUMÉRIQUE DE LA CLASSE B RESPECTE TOUTES LES EXIGENCES DU RÈGLEMENT SUR LE MATÉRIEL BROUILLEUR DU CANADA.



**Dear customer,**

Thank you for purchasing a ROYALAXE accessory product. To ensure you a reliable after-sales service, please read the following instructions carefully. This product warranty period is valid for one year from the date of purchase (the date of receipt of the return receipt and the invoice date of the buyer).

**The following situations are not covered by after-sales service :**

1. Unable to provide a valid warranty card and invoice (not including those that can prove the products is within the valid warranty period) or the alteration of the warranty without authorization.
2. The product model and serial number on the warranty card are not in conformity with the physical product or without the distributor seal.
3. The model number, serial number or production date code on the product has been altered, removed or made illegible.
4. The defect is the result of excessive use outside the intended purpose, e.g. non-stop use in a commercial environment.
5. Damage due to not used in accordance with product instructions.
6. Damage caused by the use of pirated software or computer virus during use.
7. Damage caused by accident, damage, or repair from unauthorized service vendors.
8. Damage caused by force majeure.
9. The product does not work properly due to missing connection caused by accident, signal interference or other influential factors during use.
10. For normal wear and tear defects, or by their nature consumable parts.
11. The product does not function properly because it was not originally designed, manufactured or approved for use in the country where you use the product, which might occur when you imported the product.

If the functions of the product which you had purchased are defected or can not be used normally, please contact your local retailer.

The serial number of the product filled in the form must be consistent with the actual product. This certificate the primary instrument for the after-sales service, please safe keep it. If you need technical support, please show this warranty card, and we will provide quality and professional services.

Commodity Information	Name	
	Place of origin	
	Model No.	
	Serial No.	
User info.	Name	
	Address	
	Tel.	
	Postcode	
Sales info.	Retailer	
	Address	
	Tel.	
	Postcode	
	Sale date	
	Invoice No.	
	Stamp & Signature	
<p>Dear customer, the above information is to be filled in by the seller. Please cooperate with us. Thank you!</p> <p>The following information shall be filled in by the maintenance agency and returned to the customer.</p>		
Maintenance info.	Maintenance company name	
	Address	
	Tel.	
	Postcode	
	Document No.	
	Date	
	Signature	